



ATRO is an ISO 9001 Registered Manufacturer of Polyurethane Components for the Heavy-Duty Suspension Industry

Installation Instructions for Hendrickson Bar Pin Bushing Kit

(ATRO® p/n #EB50-21013)

ATRO QUALITY... MOLDING THE FUTURE

Please read instructions carefully. Warranty is void if installed improperly.

KIT CONTAINS:

- (1) bar pin bushing
- (2) bolts
- (2) lock nuts
- (4) spacer washers
- (4) flat washers

RECOMMENDED INSTALLATION TOOL:

End beam bushing press in tool (ATRO® p/n PT50-21013)

- 1) Remove old bushing from beam.
- 2) Press new bushing into beam using ATRO® p/n PT50-21013 (or equivalent).
- 3) Install beam, using (4) spacer washers (thick) for spacing and/or alignment between bar pin and bracket as needed.
- 4) Use (4) flat washers (thin) outside of bracket for bracket to bolt head and bracket to nut.

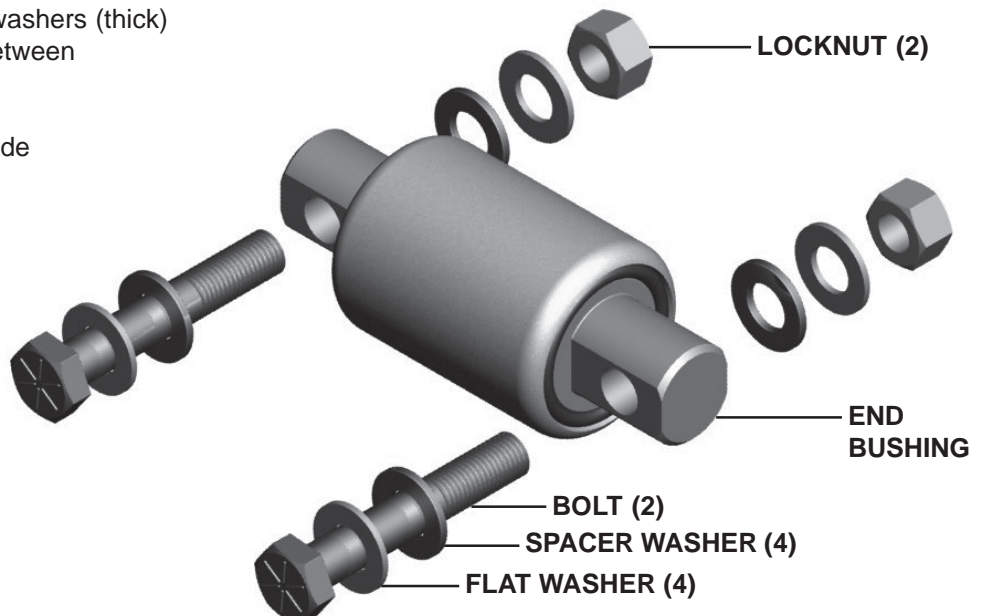

**PROUDLY MADE IN
SULLIVAN, MISSOURI ★ U.S.A.**



1250 Airport Road, Sullivan, Missouri 63080 USA
(800) 325-6114 • Fax: (573) 860-8401
www.atrobushing.com • email sales@atrobushing.com

©2007 ATRO ENGINEERED SYSTEMS, INC. ALL RIGHTS RESERVED.

EB50-210131107