

ATRO

Parts Guide

Hood Latch

Assemblies
Latches
Kits



ATRO Parts. Performance that drives your success.

ATRO, LLC | 6 Bolte Lane | St. Clair, MO 63077 USA | Customer Support (800) 325-6114

www.atrobushing.com

© 2025 ATRO, LLC

Product Spotlight

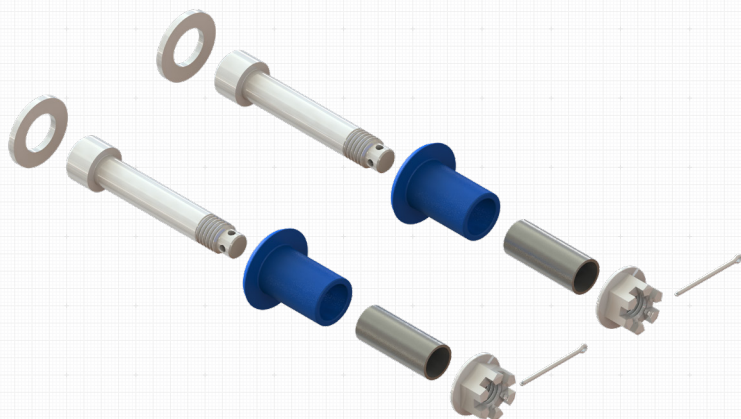

HM75-64001 (CAD Rendering)
Hood Pivot Bushing Kit

Hood Components

Unmatched durability and performance.

Designed and engineered with our custom polyurethane formulas for unmatched durability and performance. Built tough for heavy-duty trucks, they won't degrade when exposed to chemicals and weather.

- ATRO polyurethanes are 3-5 times stronger than rubber.
- Resistant to oils, grease, road salt, and other chemicals.
- Specific compounds optimize the performance of each part.



The ATRO Difference—material, function, and design.

We build parts tough for the heavy-duty industry.



Full line of hood components.

- Includes hood latches and hood latch assemblies, mounting bushings, stops, guides, bumpers, insulators, supports, brackets, pivot bushings, hinge bushings, and rollers.

Durability and strength.

- Heavy-duty construction.
- Poly won't degrade when exposed to chemicals and weather.
- Designed for optimal performance and continuous use on trucks.

Industry best warranty.

- You can trust ATRO Parts to perform better and last longer.



HL00-64003 (CAD Rendering)
Hood Latch Kit



HL00-64001

Hood Latch

LG: 8.75"
WD: 2.3"

Freightliner:
A680880160,
680-880-01-60

Peterbilt: 1304339, 161037,
23-13857, L56-0001

Included in Kits HL00-64003, HL00-64004



HL00-64002

Hood Latch Catch

LG: 3.5"
WD: 1"
H: 2.1"

Freightliner: 17-14781-000

Kenworth: L03-0001

Peterbilt: L03-0001

Volvo: 671120003, 671120004,
671123801, 8174018

*Included in Kits HL46-64530, HL46-64531,
HL96-64018*



HL00-64003

Hood Latch Kit

Contains:

- (1) HL00-64001
- (1) HL00-64002
- (1) Bracket
- (1) Bolt
- (1) Nut

PACCAR: 63011005,
63011005A, L56-0001

Peterbilt: 161037 Latch Only, 23-13857



HL00-64004

Hood Latch Kit

Contains:

- (2) HL00-64001
- (2) HL00-64002
- (2) Bracket
- (2) Bolt
- (2) Nut

PACCAR: 63011005,
63011005A, L56-0001

Peterbilt: 23-13857



HL00-64005

Hood Latch Assembly

LG: 4 15/16" C-C (Strap)

Kenworth: 37-99-344,

Mack: 25159428,
25169065, 3QM313M,
3QM313M2

Peterbilt: 37-41-295-60, 374129560

Included in Kits HL00-64006, HL00-64007



HL00-64006

Hood Latch Kit, Right

LG: 4 15/16" C-C

Contains:

- (1) HL00-64005
- (1) Catch Bracket, Right

Bluebird: 37-41-295-60, 55554

Mack: 25165475, 25169065
3QM313M2, 3QM314M

Catch Bracket Not Sold Separately



HL00-64007

Hood Latch Kit, Left

LG: 4 15/16" C-C

Contains:

- (1) HL00-64005
- (1) Catch Bracket, Left

Bluebird: 25159428

Mack: 25159428, 25165476, 3QM313M,
3QM315M

Catch Bracket Not Sold Separately



HL46-64339

Hood Latch Assembly

LG: 8.75

WD: 2.25

MISC: 3.75" Pivot to latch

Contains:

- (1) HL00-64001 Hood Latch
- (1) Bracket
- (1) Rivet

Peterbilt: 1304339

Catch Bracket Not Sold Separately



HL46-64434

Hood Latch Catch

LG: 4 7/8"

WD: 1.0"

MISC: 1.25" Bolt Hole C-C

Freightliner:

17-12434-000

*Included in Kits HL46-64480, HL46-64650,
HL46-64651*



HL46-64435

Hood Latch

LG: 11.25"

MISC: 5.75" Pivot to Tab

Contains:

- (1) HL00-64005
- (1) Catch Bracket, Left

Freightliner: 17-12435-000

*Included in Kits HL46-64480, HL46-64530,
HL46-64531, HL46-64650, HL46-64651*



HL46-64480

Hood Latch Kit

LG: 11 1/4"

MISC: 5.75" Pivot Center
to Latch

Contains:

- (1) HL46-64434
- (1) HL46-64435

Freightliner: 17-12348-000,
17-12434-000, 17-12438-000



HL46-64530

Hood Latch Kit, Left

Contains:

- (1) HL00-64002
- (1) HL46-64435

Freightliner: A17-15553-000



Hood Latch Guide

HL46-64531

Hood Latch Kit, Right

Contains:

- (1) HL00-64002
- (1) HL46-64435

Freightliner:

A17-15553-001



HL46-64650

Hood Latch Kit, Left

LG: 11 1/4"

MISC: 5.75" Pivot Center to Latch

Contains:

- (1) HL46-64434
- (1) HL46-64435

Freightliner: 17-12434-000,
17-12435-000



HL46-64651

Hood Latch Kit, Right

Contains:

- (1) HL46-64434
- (1) HL46-64435

Freightliner:

17-12434-001,
17-12435-001



HL55-644C1

Hood Latch Kit, Right

LG: 12 5/8"

Navistar: 3544924C1



HL55-64C91

Hood Latch Kit

LG: 6 7/8" C-C

International:

1699929C91,
1699930C92,
1699930C93



HL59-64027

Hood Latch Assembly

LG: 3 1/8" C-C

Kenworth: L56-1042

PACCAR: L56-6027



HL59-64033

Hood Latch Kit

LG: 5"

Kenworth: L56-6033,
L56-6048, L566033

PACCAR: L56-1049



HL59-64107

Hood Latch

LG: 5 1/2"

Kenworth: K147-107,
K147C106

Peterbilt: K147-107



HL75-64372

Hood Latch Assembly

LG: 8 1/16" Overall

MISC: 4 15/16" C-C Pivot to Pivot

PACCAR: 37-99-363



HL75-64373

Hood Latch Assembly

LG: 8 1/16" Overall

MISC: 4 15/16" C-C Pivot to Pivot

PACCAR: 37-99-363

*Found on Peterbilt 587
with Aero Hood and others*



HL96-64000

Hood Latch

LG: 12.5" Overall

WD: 2.5"

Volvo: 671010002
671010005, 671010006
671010007, 671010008
8174018



Included in Kit HL96-64018

HL96-64018

Hood Latch Kit

Contains:

- (1) HL00-64002
- (1) HL96-64000

Volvo: 1118205, 8174018



ATRO Website Tools And Digital Assets

Find the resources you need.

We've designed and built our website with a full set of tools to help you search, find, and get details about ATRO parts.

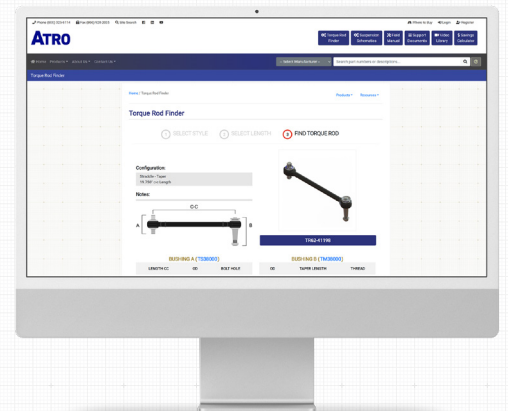

ATRO Parts. Performance that drives your success.

ATRO, LLC | 6 Bolte Lane | St. Clair, MO 63077 USA | Customer Support (800) 325-6114

www.atrobushing.com

© 2025 ATRO, LLC